

# Ice Cream Display Chest Freezer

SKU: 15000-765    15000-766    15000-767    16000-830    16000-657



Zanduco's ice cream freezer is built to both showcase products and drive higher sales of frozen novelties and seasonal treats. Its flat glass top provides a clear, attractive display, allowing customers to easily view what's inside and make quick purchasing decisions. With a spacious interior, it offers ample storage to keep a wide variety of frozen items well-organized and readily available. Designed with ice cream parlours, convenience stores, and supermarkets in mind, this sleek and visually appealing unit combines functionality with style, making it a reliable solution that can handle the everyday demands of busy commercial environments.

Made in China



<p><b>NEMA</b> 5 - 15P 125VAC / 15 AMP</p> 
--

**1 YEAR**  
**WARRANTY**  
PARTS & LABOUR



**TECHNICAL DRAWING**

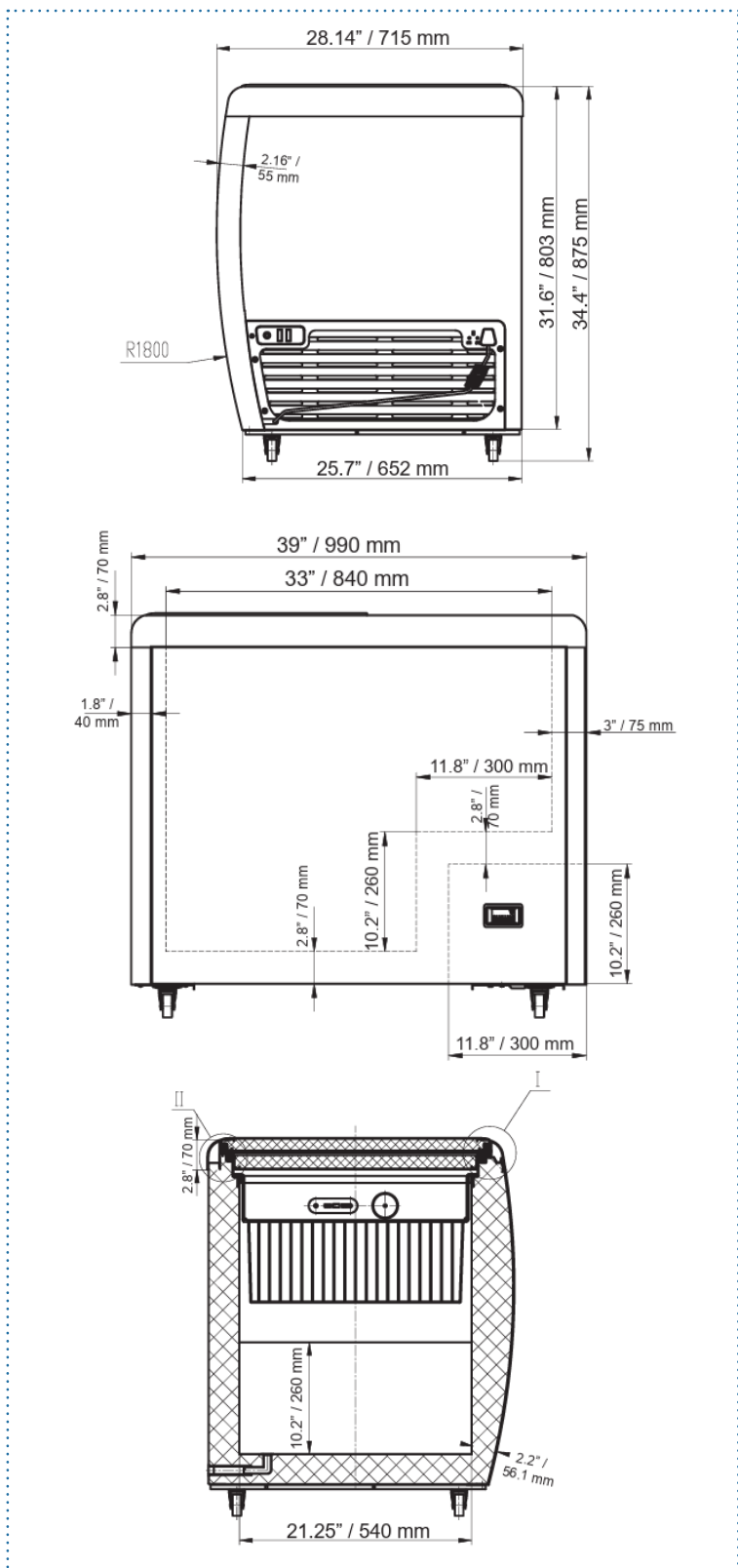

**TECHNICAL SPECIFICATION**

SKU	15000-766
Capacity	9.5 cu.ft.
Compressor Power	1/3 + HP
Power	265W
Amps	3.5
Number of Doors	2
Number of Baskets Included	3
Max. Number of Baskets that can Fit	3
Temperature Range	-26°C to 4°C   -15°F to 40°F
Refrigerant	R290
Electrical	110V / 60Hz / 1Ph
Net Dimensions (WDH)	39" x 28.14" x 34.4" 715 x 990 x 875 mm
Net weight	128 lb.   58 kg.
Gross Dimensions	47" x 36" x 45" 1194 x 915 x 1143 mm
Gross Weight	155 lb.   70.3 kg.



## TECHNICAL DRAWING

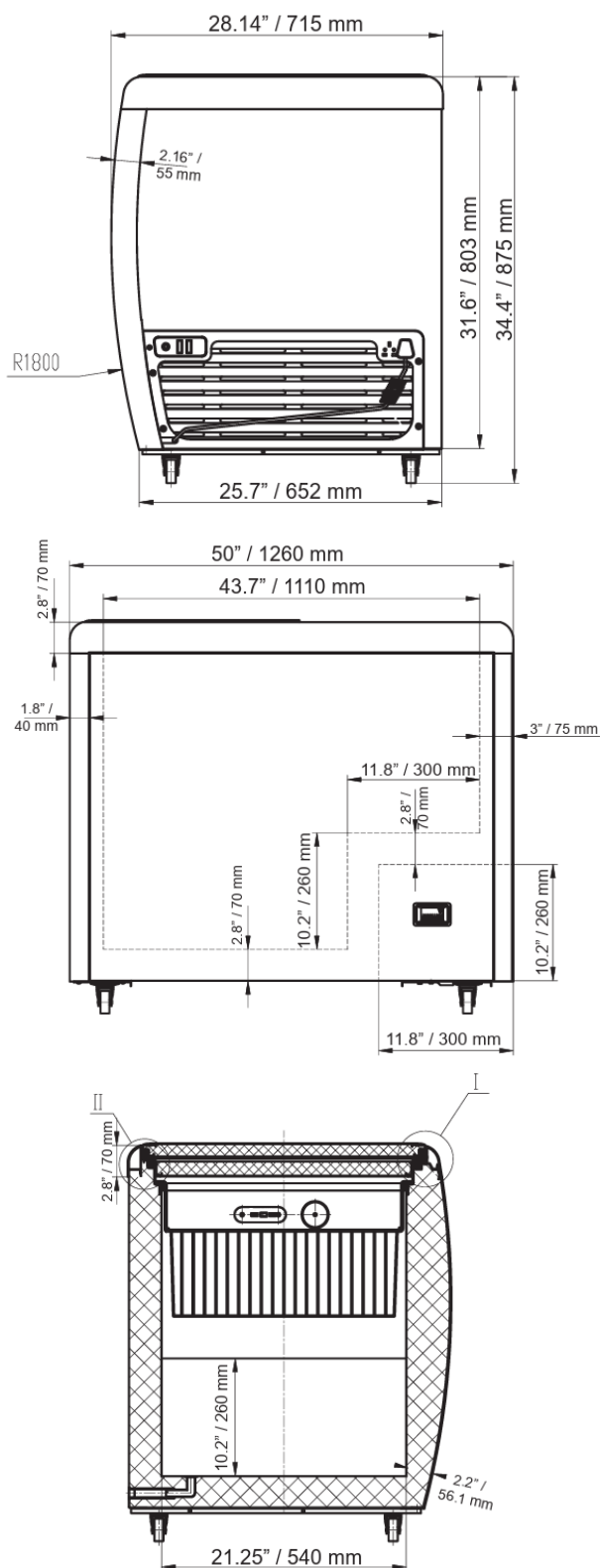

## TECHNICAL SPECIFICATION

SKU	15000-767
Capacity	13.1 cu.ft.
Compressor Power	2/5 + HP
Power	270W
Amps	4
Number of Doors	2
Number of Baskets Included	4
Max. Number of Baskets that can Fit	4
Temperature Range	-26°C to 4°C   -15°F to 40°F
Refrigerant	R290
Electrical	110V / 60Hz / 1Ph
Net Dimensions (WDH)	50" x 28.14" x 34.4" 715 x 1260 x 875 mm
Net weight	154 lb.   70 kg.
Gross Dimensions	54" x 36" x 45" 1372 x 915 x 1143 mm
Gross Weight	185 lb.   84 kg.



## TECHNICAL DRAWING

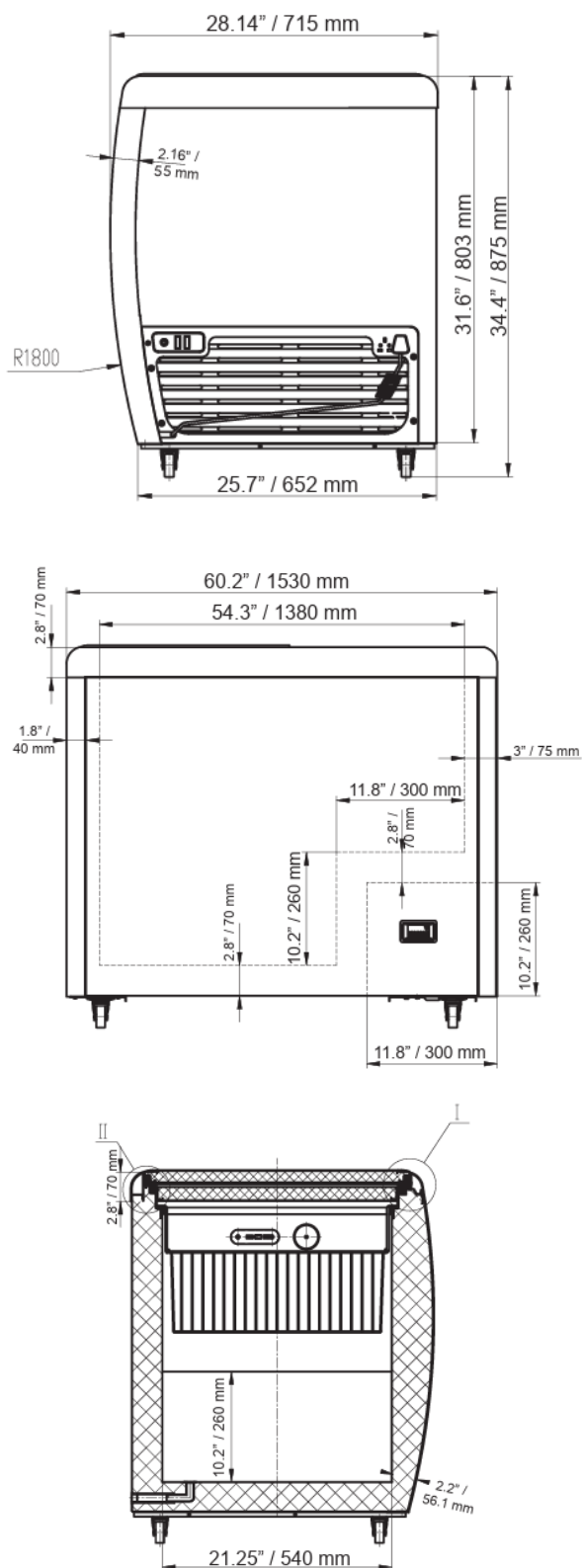

## TECHNICAL SPECIFICATION

SKU	16000-830
Capacity	16.6 cu.ft.
Compressor Power	1/2 + HP
Power	330W
Amps	4
Number of Doors	2
Number of Baskets Included	5
Max. Number of Baskets that can Fit	5
Temperature Range	-26°C to 4°C   -15°F to 40°F
Refrigerant	R290
Electrical	110V / 60Hz / 1Ph
Net Dimensions (WDH)	60.2" x 28.18" x 34.4" 715 x 1530 x 875 mm
Net weight	172 lb.   78 kg.
Gross Dimensions	66" x 36" x 45" 1677 x 915 x 1143 mm
Gross Weight	225 lb.   102 kg.



**TECHNICAL DRAWING**

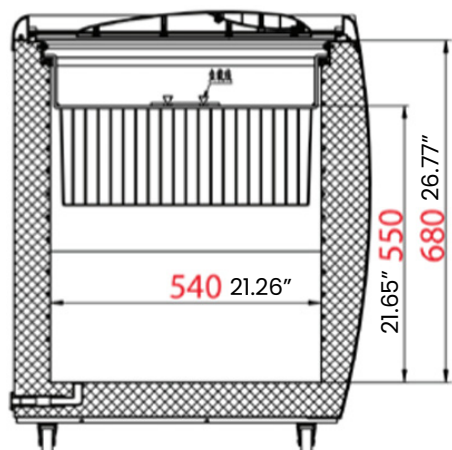
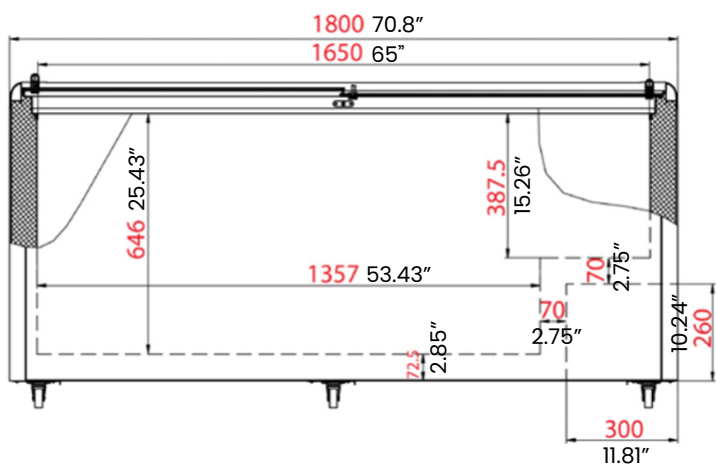
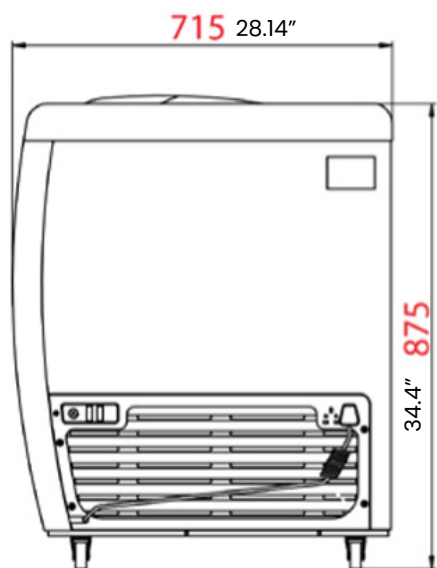

**TECHNICAL SPECIFICATION**

SKU	16000-657
Capacity	20 cu.ft.
Doors	2 Sliding Doors
Baskets	6
Basket Capacity	2 x 3 Gallon Tubs / 24 kg. ea
Temperature Range	-26°C to 4°C   -15°F to 40°F
Refrigerant	R290
Power	295W
Amperage	4A
Electricals	115V / 60Hz / 1Ph
Compressor	2/3 HP+
Net Dimensions (WDH)	70.9" x 28.14" x 34.4" 1800 x 715 x 875 mm
Net weight	194 lb.   88 kg.
Gross Dimensions	77" x 36" x 45"
Gross Weight	240 lb.   108.9 kg.

